

QR2 CORE | MANUAL

Precision CNC machined from a single block of aluminum alloy

Surface sandblasted and undergoes anodization treatment

Compatible with 70mm hole steering wheels

Compatible with Fanatec QR2 Base-Side (Type-M) and Fanatec QR2 Base-Side (Type-C)

The built-in chip can unlock the torque of the Fanatec base

LEDX1

Notes

- Please read the user guide manual completely before installing or operating the racing wheel.
- When connecting the racing wheel to the base, make sure that it is firmly attached before turning off the power.
- Any modifications, disassemble, tampering, changes or unauthorized uses of the product will void the warranty.
- The product should not be used in wet or liquid environments and should be kept away from high temperatures, low temperatures, and direct sunlight.
- This product is designed for simulation use only.
- Leoxz is responsible for revising and explaining this manual, and reserves the right to make changes or corrections to the information and explanation provided without prior notice and without any responsibility.

What's included

- QR2 Core Wheel-Side
- 6 x M5x16 hex bolts
- 6 x M5x9 washer
- 1 x Allen key 4 mm

Wheel Bases Compatibility

- Podium Wheel Base DD1 (after QR2 upgrade)
- Podium Wheel Base DD2 (after QR2 upgrade)
- Podium Racing Wheel F1® (after QR2 upgrade)
- CSL DD (with QR2 upgrade)
- Gran Turismo DD Pro (with QR2 upgrade)

QR Installation

QR2 Core has 10 mounting holes with a diameter of 70mm for quick release installation, including 6 through holes and 4 threaded holes.

6 through holes will have a downward offset of 0.8mm from QR2 Core center point, 4 threaded holes are positioned at QR2 Core center point.

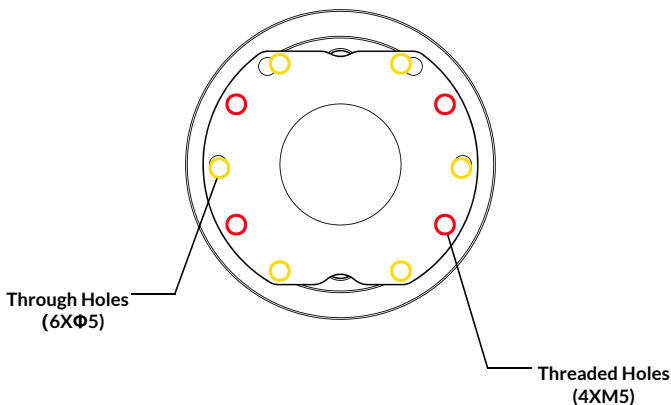

QR Installation

The maximum torque for the bolts should not exceed 2.5 Nm.

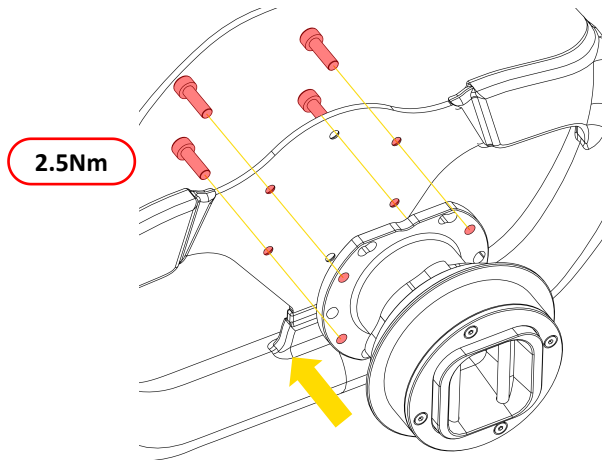

LEOX1

www.leoxz.com

support@leoxz.com

Copyright © 2023 Leoxz® All Rights Reserved